

## PLASTIC PARTS

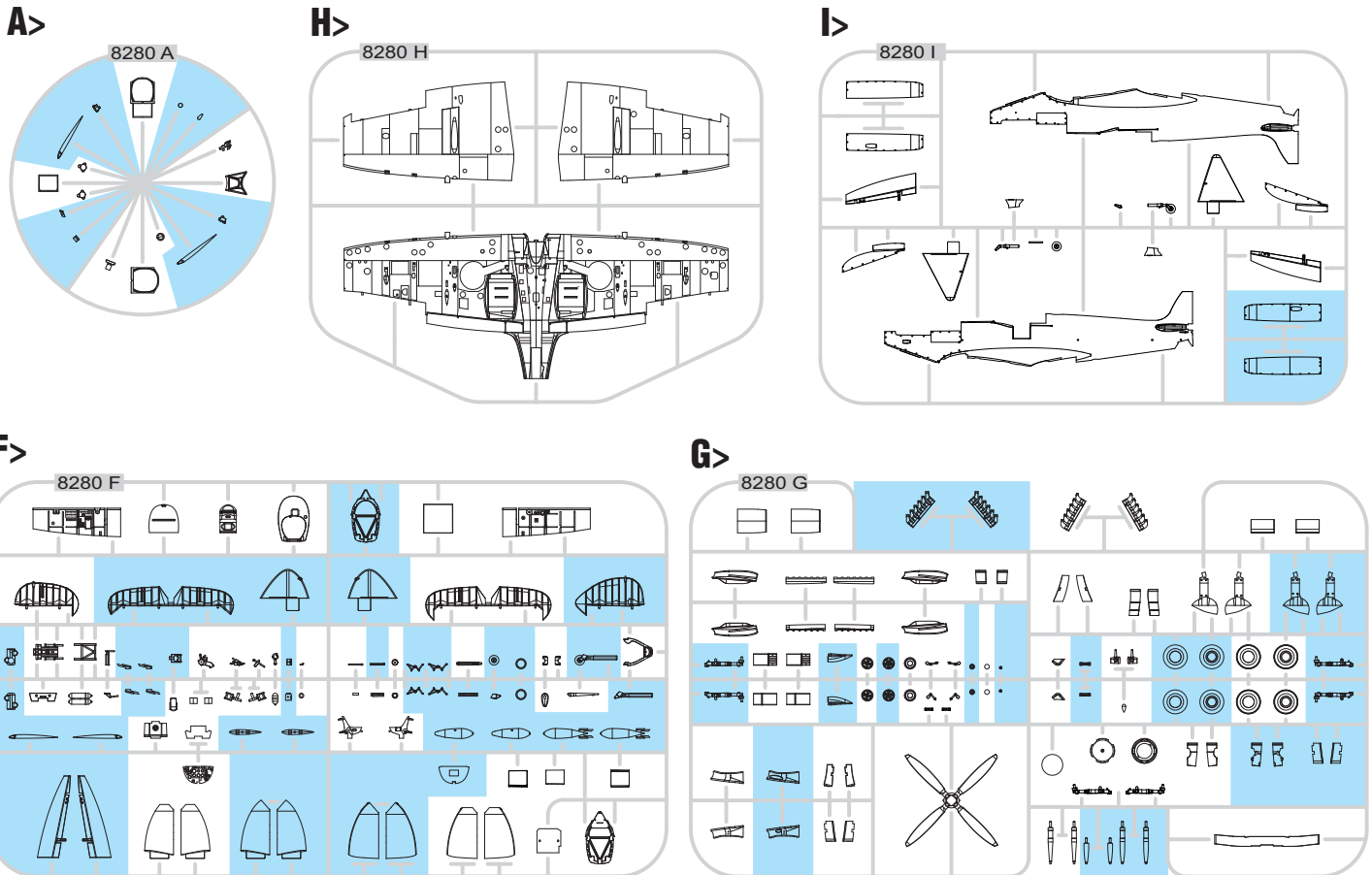

GUNZE	MISSION MODELS	
H4	C4	MMP-007 YELLOW
H12	C33	MMP-047 FLAT BLACK
H13	C3	MMP-003 FLAT RED
H33	C81	RUSSET
H51	C11	MMP-063 LIGHT GULL GRAY
H71	C21	MMP-076 MIDDLE STONE
H72	C362	MMP-078 DARK EARTH

GUNZE	MISSION MODELS	
H77	C137	MMP-047 TIRE BLACK
H90	C47	CLEAR RED
H94	C138	CLEAR GREEN
H335	C363	MMP-094 MEDIUM SEAGRASS
	C364	MMP-079 AIRCRAFT GRAY-GREEN
	C370	MMP-092 AZURE BLUE

MC/METAL	MC/COLOUR	MMM/METALLICS	
MC214	MMM-001		DARK IRON
MC218	MMM-003		ALUMINIUM
SM01	MMC-001		SUPER CHROME

## ATTENTION \* UPOZORNĚNÍ \* ACHTUNG \* ATTENTION

- (GB)** Carefully read instruction sheet before assembling. When you use glue or paint, do not use near open flame and use in well ventilated room. Keep out of reach of small children. Children must not be allowed to suck any part, or pull vinyl bag over the head.
- (CZ)** Před započítím stavby si pečlivě prostudujte stavební návod. Při používání barev a lepidel pracujte v dobře větrané místnosti. Lepidla ani barvy nepoužívejte v blízkosti otevřeného ohně. Model není určen malým dětem, mohlo by dojít k požití drobných dílů.
- (D)** Vor dem Zusammenbau die Bauanleitung gut durchlesen. Kleber und Farben nicht in der Nähe von offenem Feuer verwenden und für eine ausreichende Belüftung sorgen. Den Bausatz von kleinen Kindern fernhalten. Vermeiden Sie, dass Kinder Bauteile in den Mund nehmen oder sich Plastiktüten über den Kopf ziehen.
- (F)** Lire soigneusement la fiche d'instructions avant d'assembler. Ne pas utiliser de colle ou de peinture à proximité d'une flamme nue, et aérer la pièce de temps en temps. Garder hors de portée des enfants en bas âge. Ne pas laisser les enfants mettre en bouche ou sucer les pièces, ou passer un sachet vinyl sur la tête.

## INSTRUCTION SIGNS \* INSTR. SYMBOLY \* INSTRUKTION SINNBILDEN \* SYMBOLES

- (?)** OPTIONAL VOLBA
- (↶)** BEND OHNOUT
- (/)** SAND BROUSIT
- (○)** OPEN HOLE VYVRTAT OTVOR
- (↔)** SYMETRICAL ASSEMBLY SYMETRICKÁ MONTÁŽ
- (✂)** REMOVE ODŘÍZNOUT
- (↺)** REVERSE SIDE OTOČIT
- (★)** APPLY EDUARD MASK AND PAINT POUŽIT EDUARD MASK NABARVIT

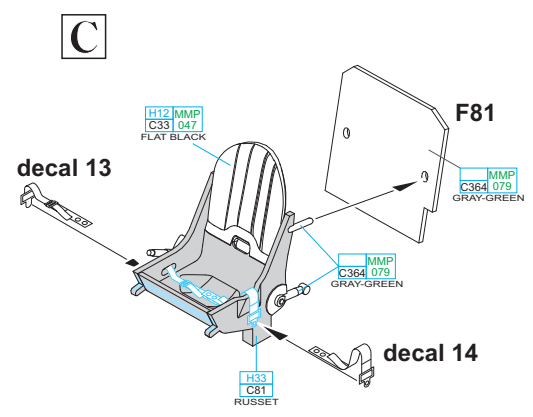
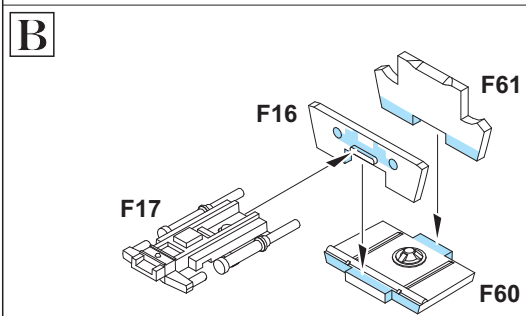
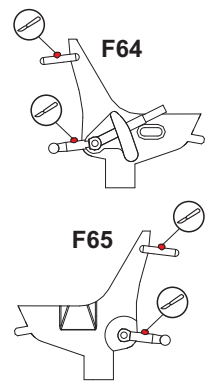
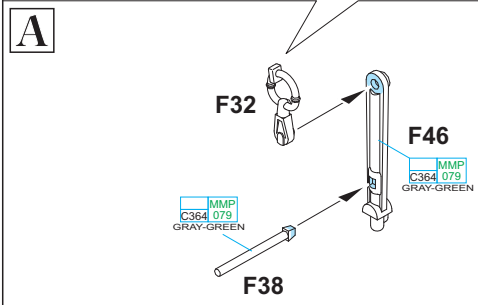
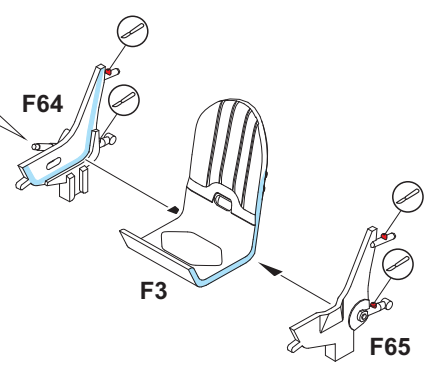
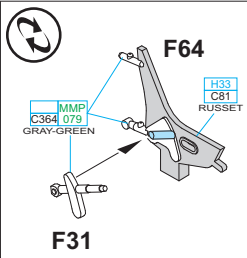
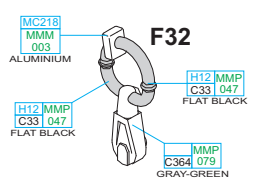
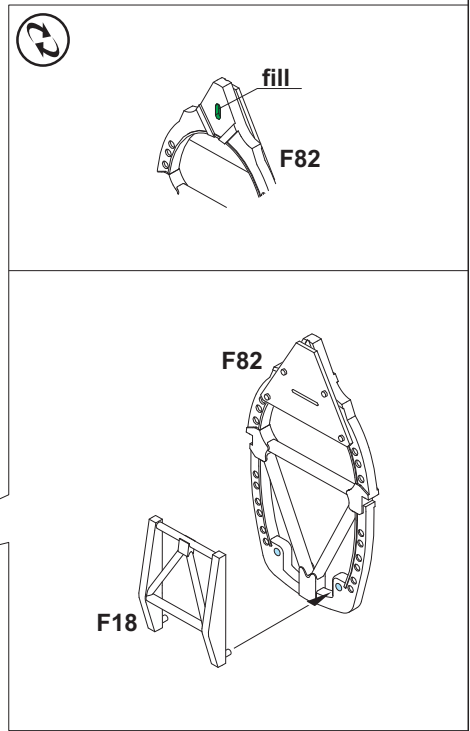
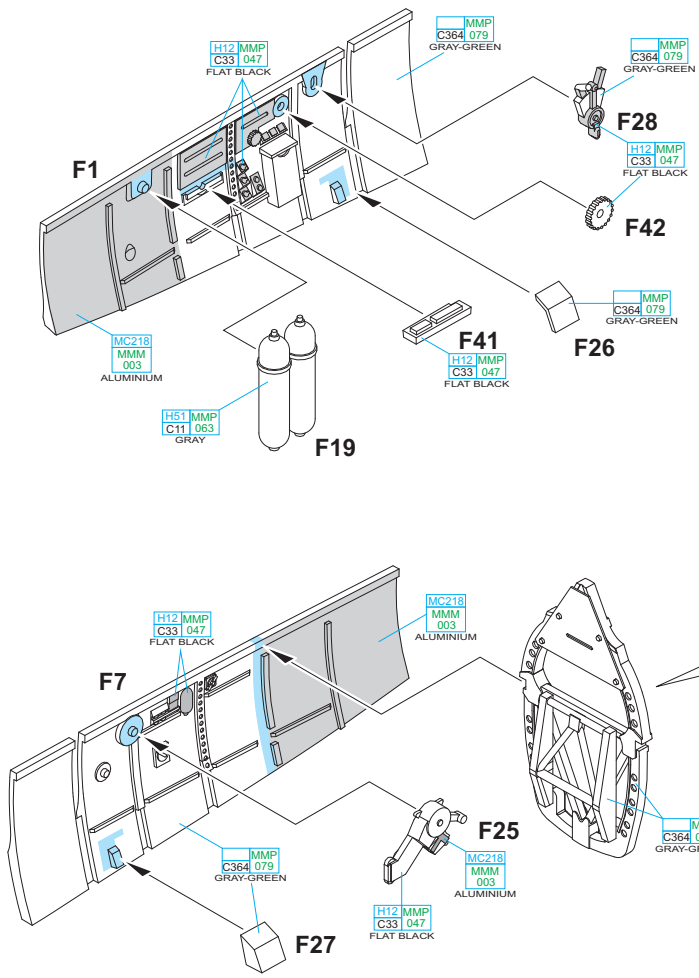

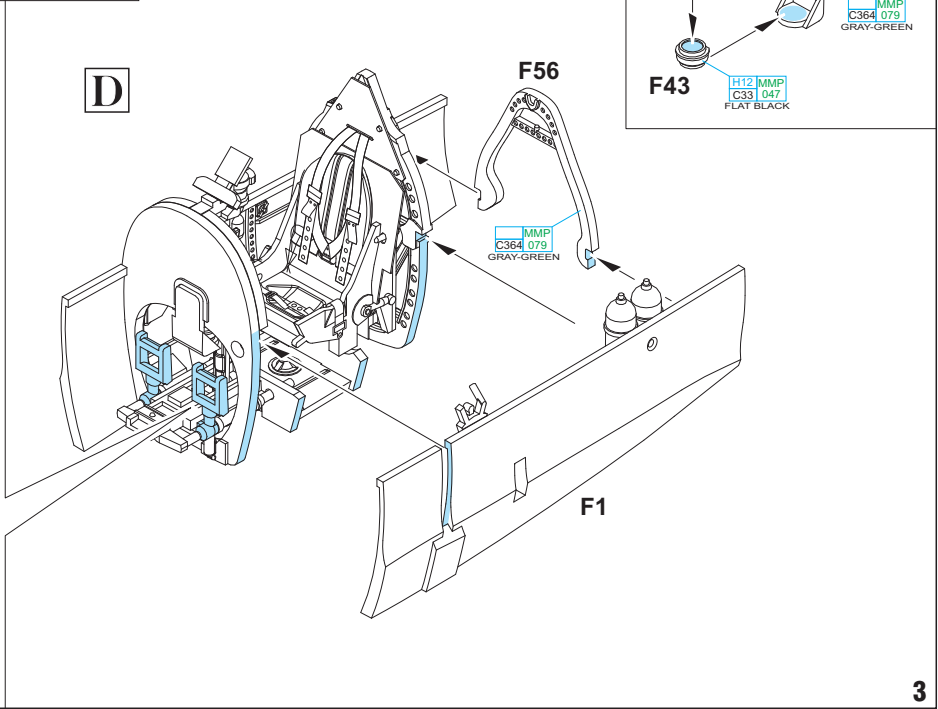
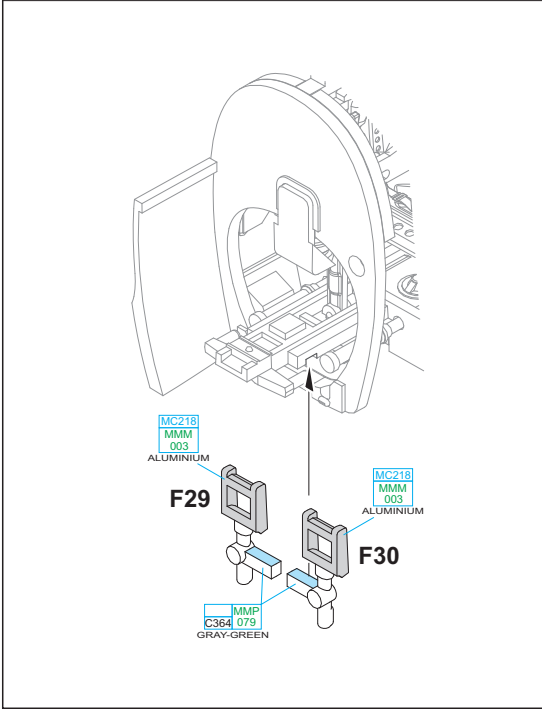
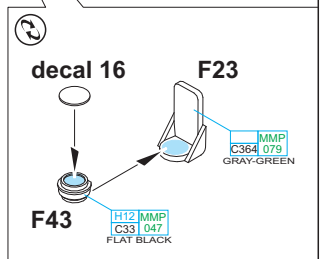
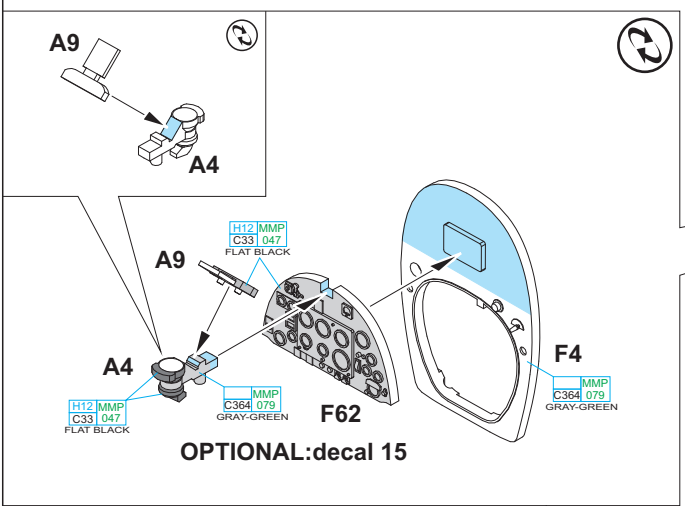
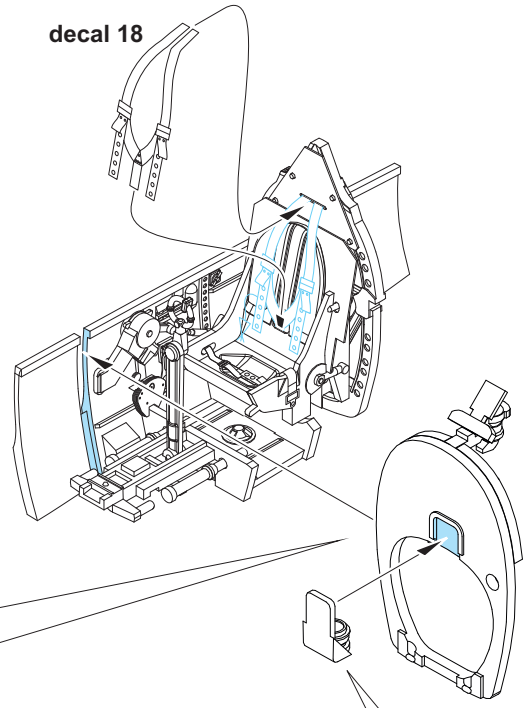
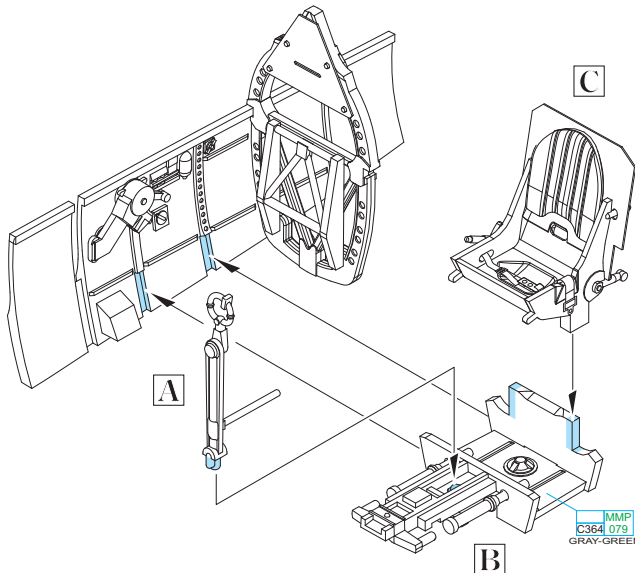

⑦ FOR CLOSED CANOPY ONLY

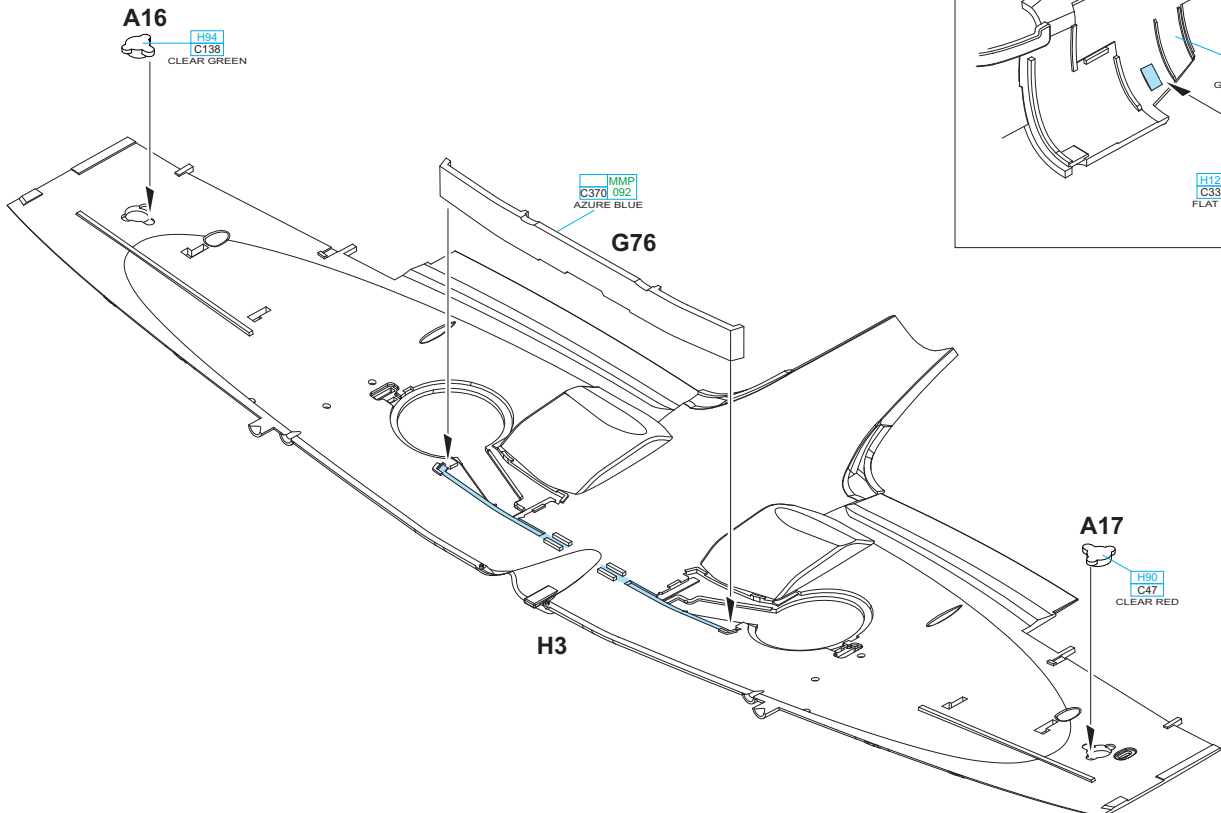
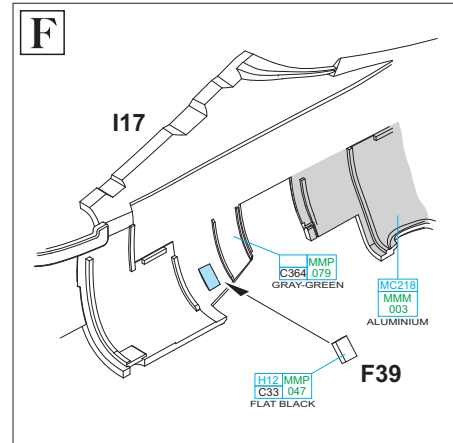
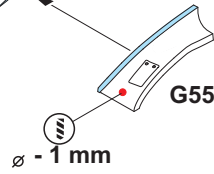
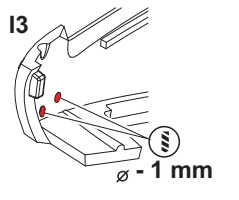
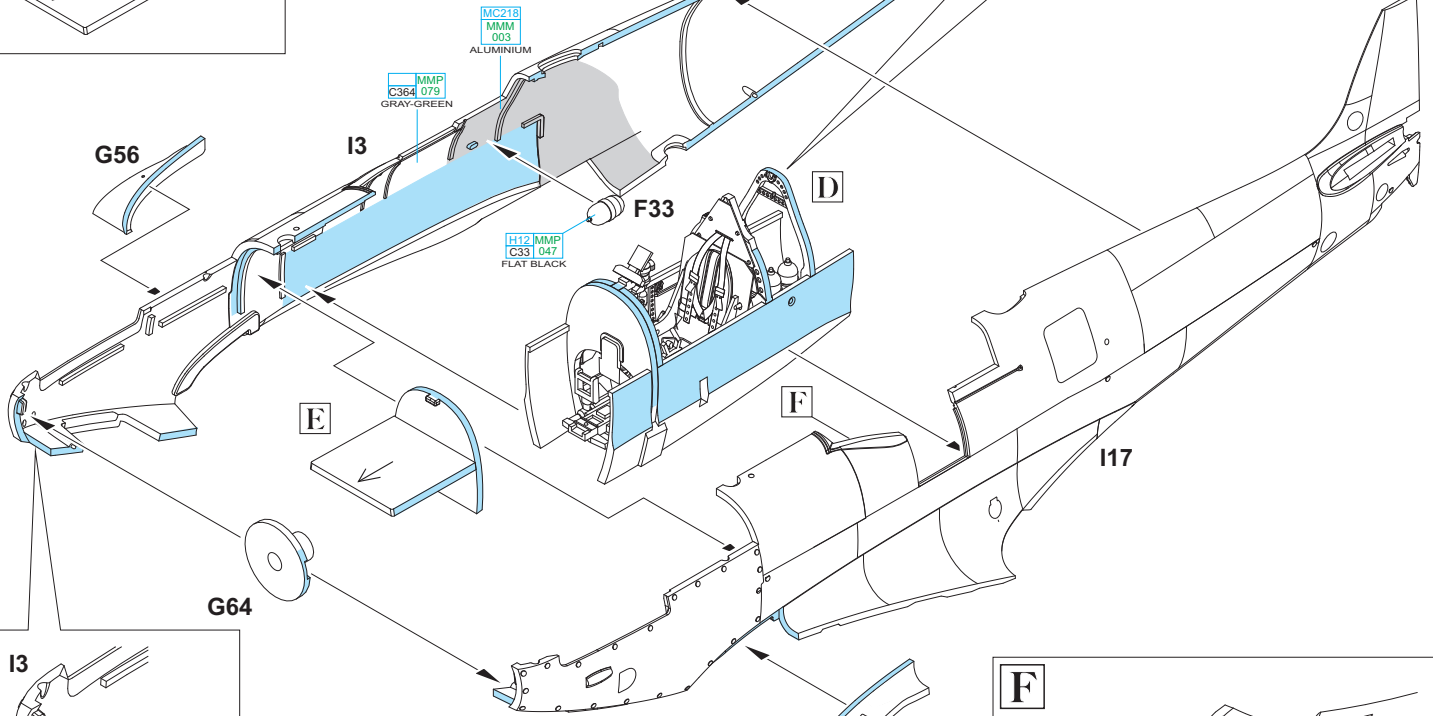
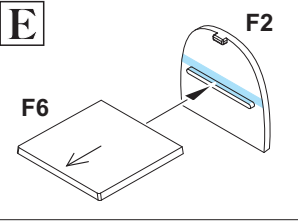
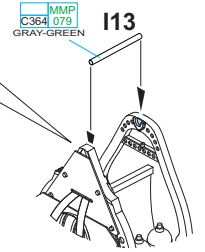
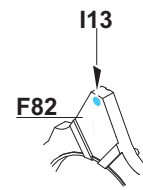
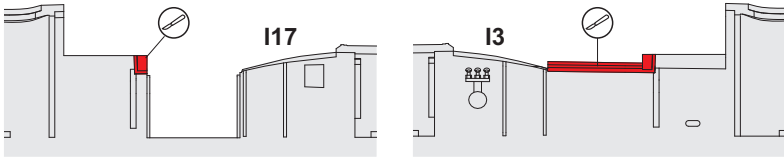

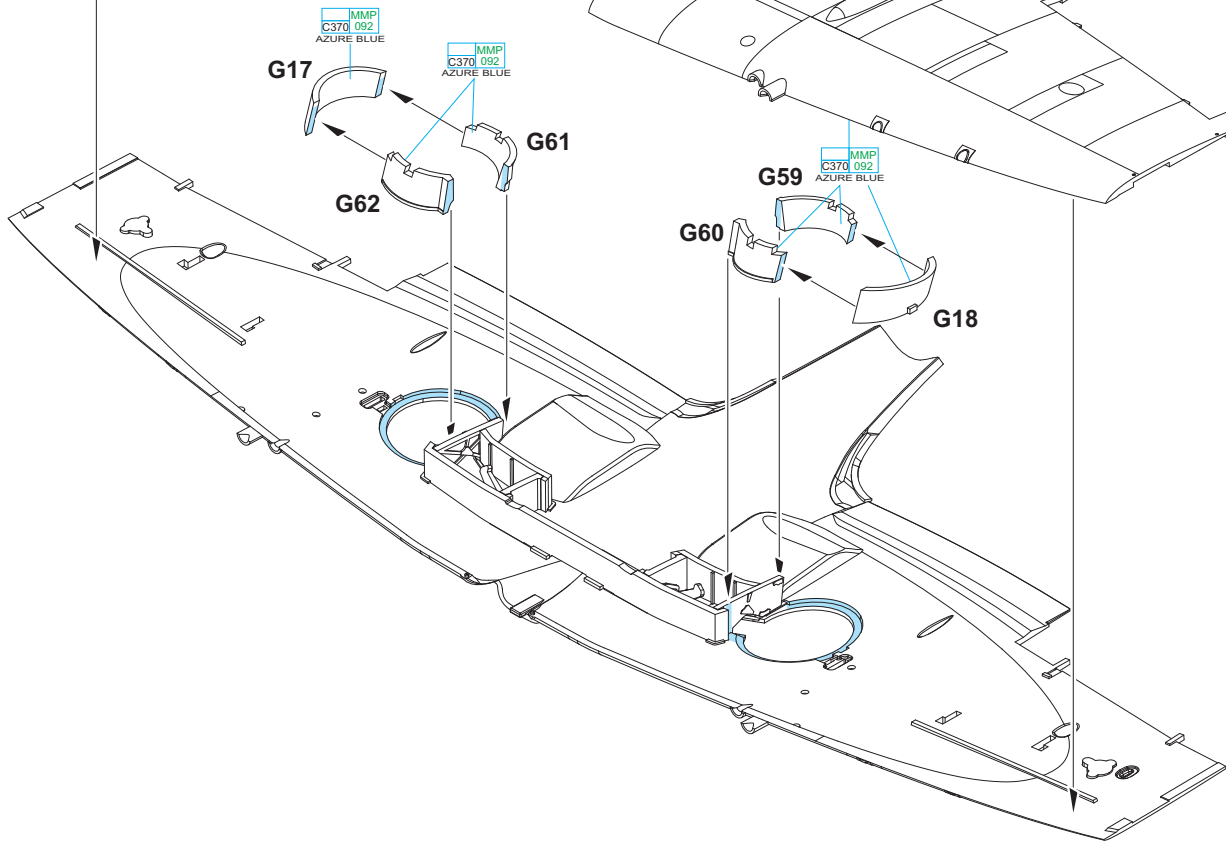
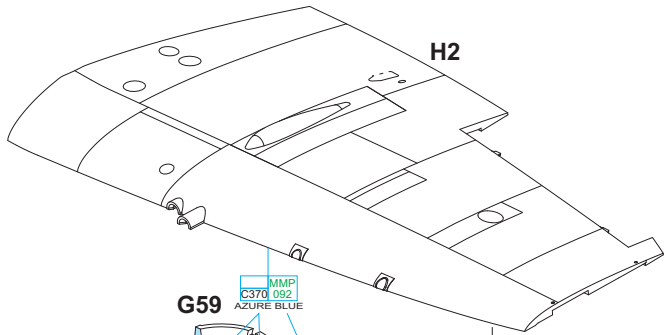
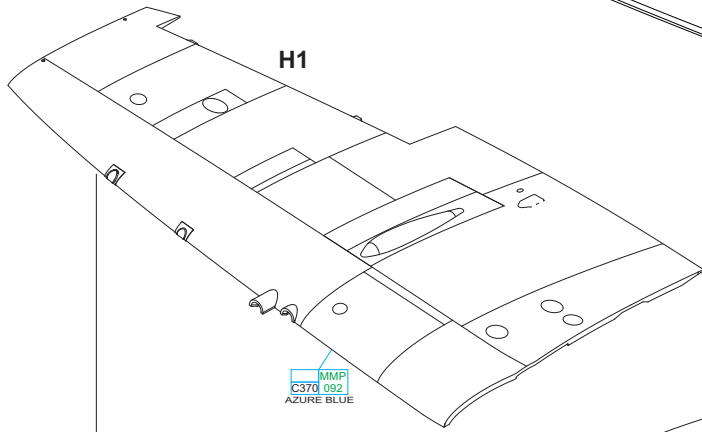
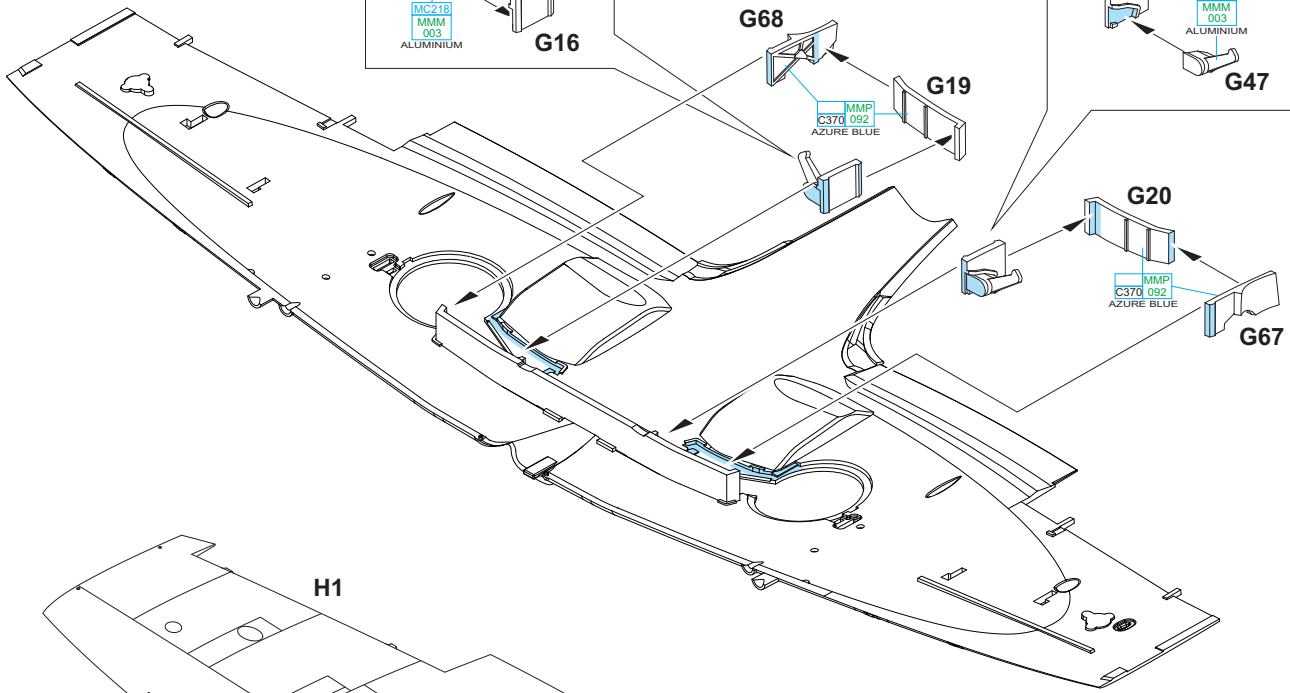
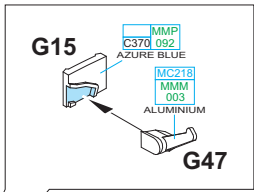
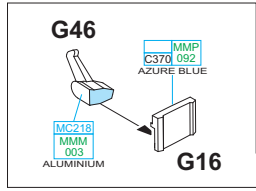

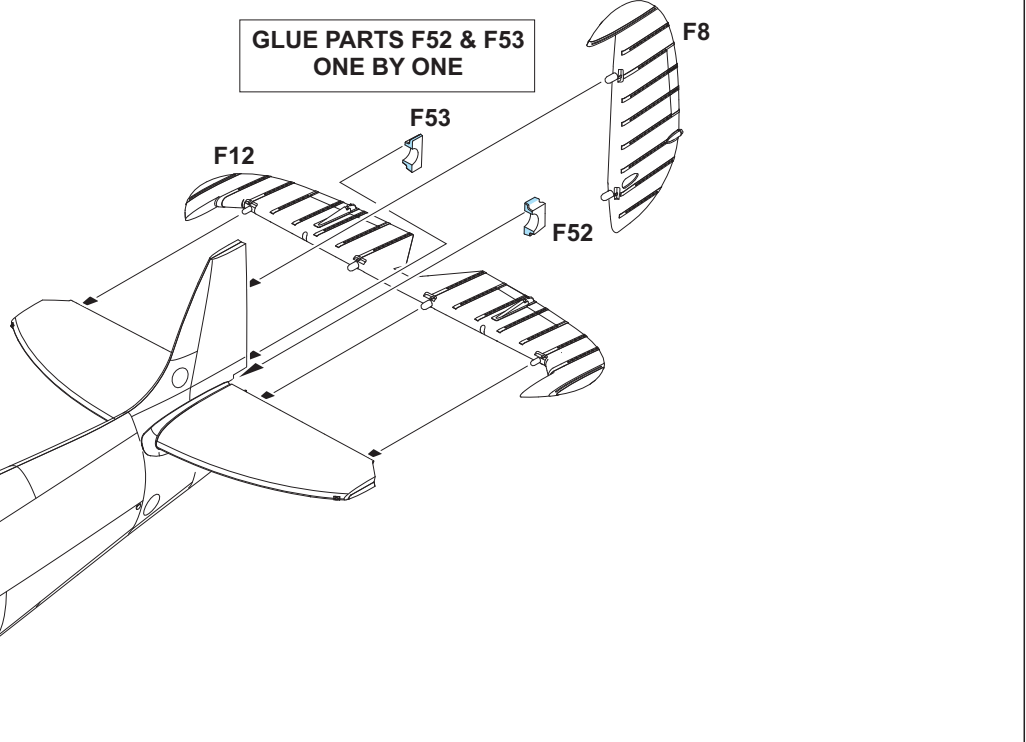
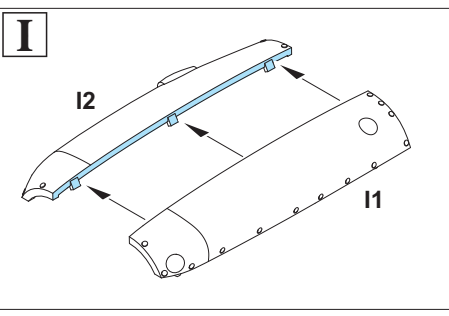
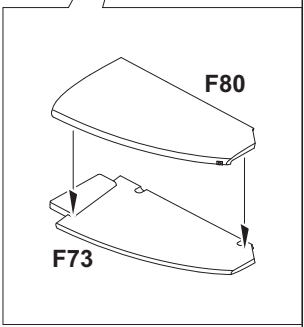
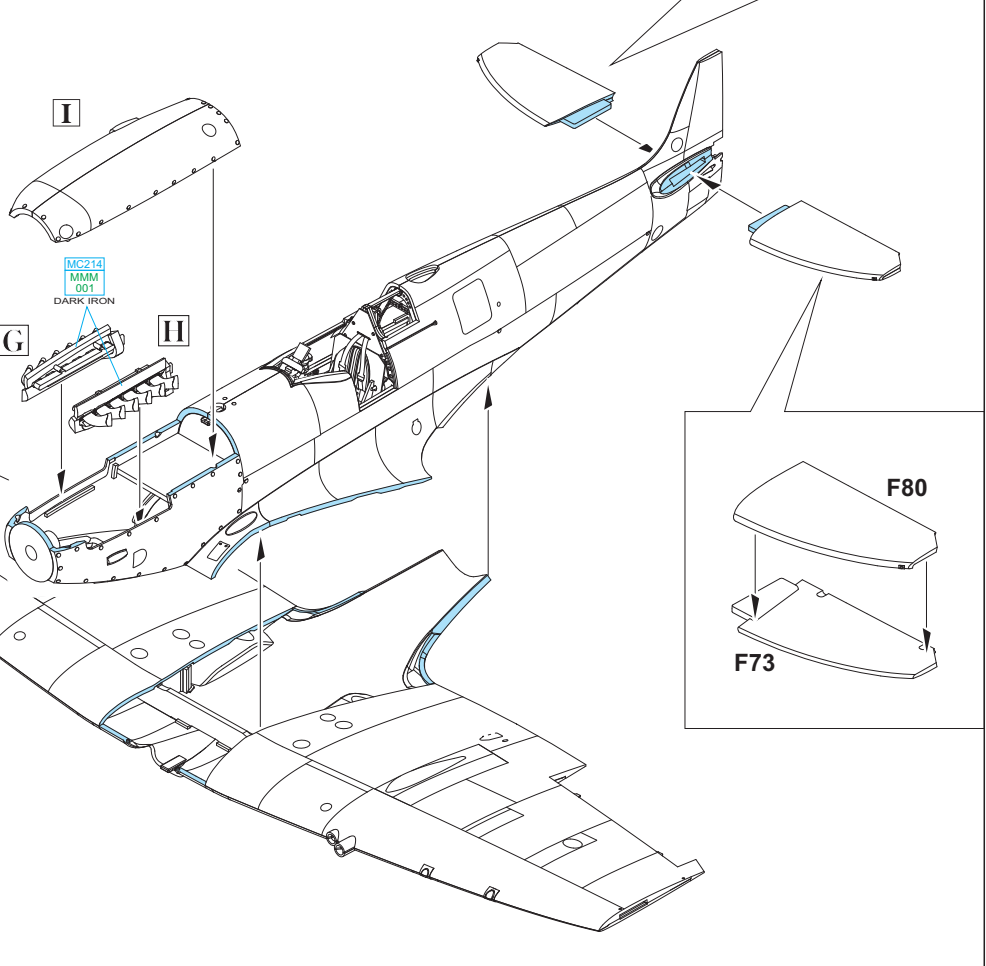
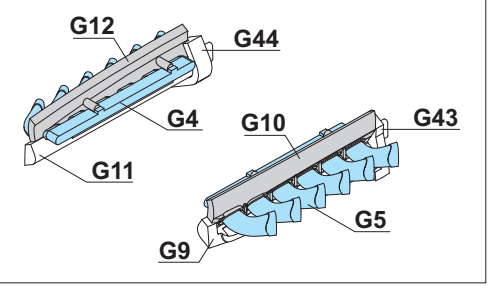
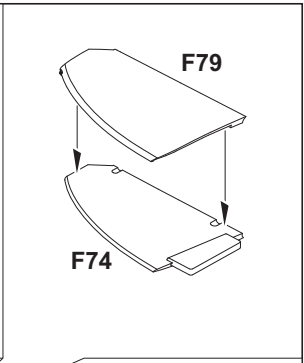
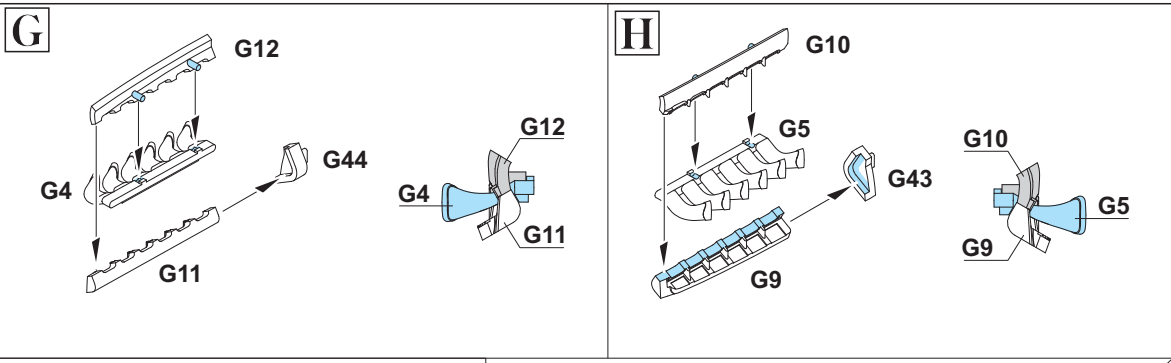

**I8**  
H94  
C138  
CLEAR GREEN

**I4**

**I16**

**J**

**I9**

**I10**

H90  
C47  
CLEAR RED

**I11**

G1 MMP  
C370 092  
AZURE BLUE

G7 MMP  
C370 092  
AZURE BLUE

G27 MC218  
MMM  
003  
ALUMINIUM

G8 MMP  
C370 092  
AZURE BLUE

G13 MMP  
C370 092  
AZURE BLUE

G1 MMP  
C370 092  
AZURE BLUE

G28 MC218  
MMM  
003  
ALUMINIUM

**G8**

F36 MMP  
C370 092  
AZURE BLUE

G30 MC218  
MMM  
003  
ALUMINIUM

G14 MMP  
C370 092  
AZURE BLUE

**G14**

**J**

**G48**

G6 MMP  
C370 092  
AZURE BLUE

**G6**

G6 MMP  
C370 092  
AZURE BLUE

**G6**

G37 right ↔ G39 left

G37 ↔ G39

G38 right ↔ G36 left

G38 ↔ G36

G6 MMP  
C370 092  
AZURE BLUE

G6 MMP  
C370 092  
AZURE BLUE

?

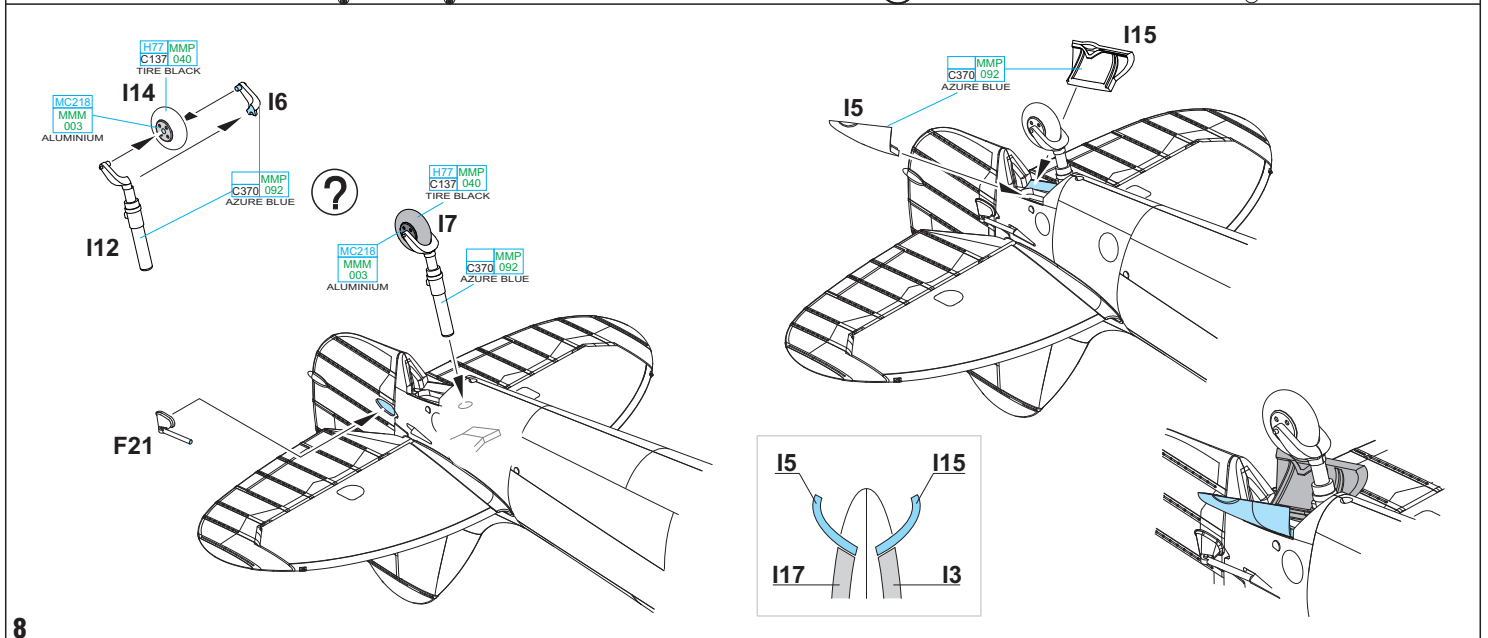
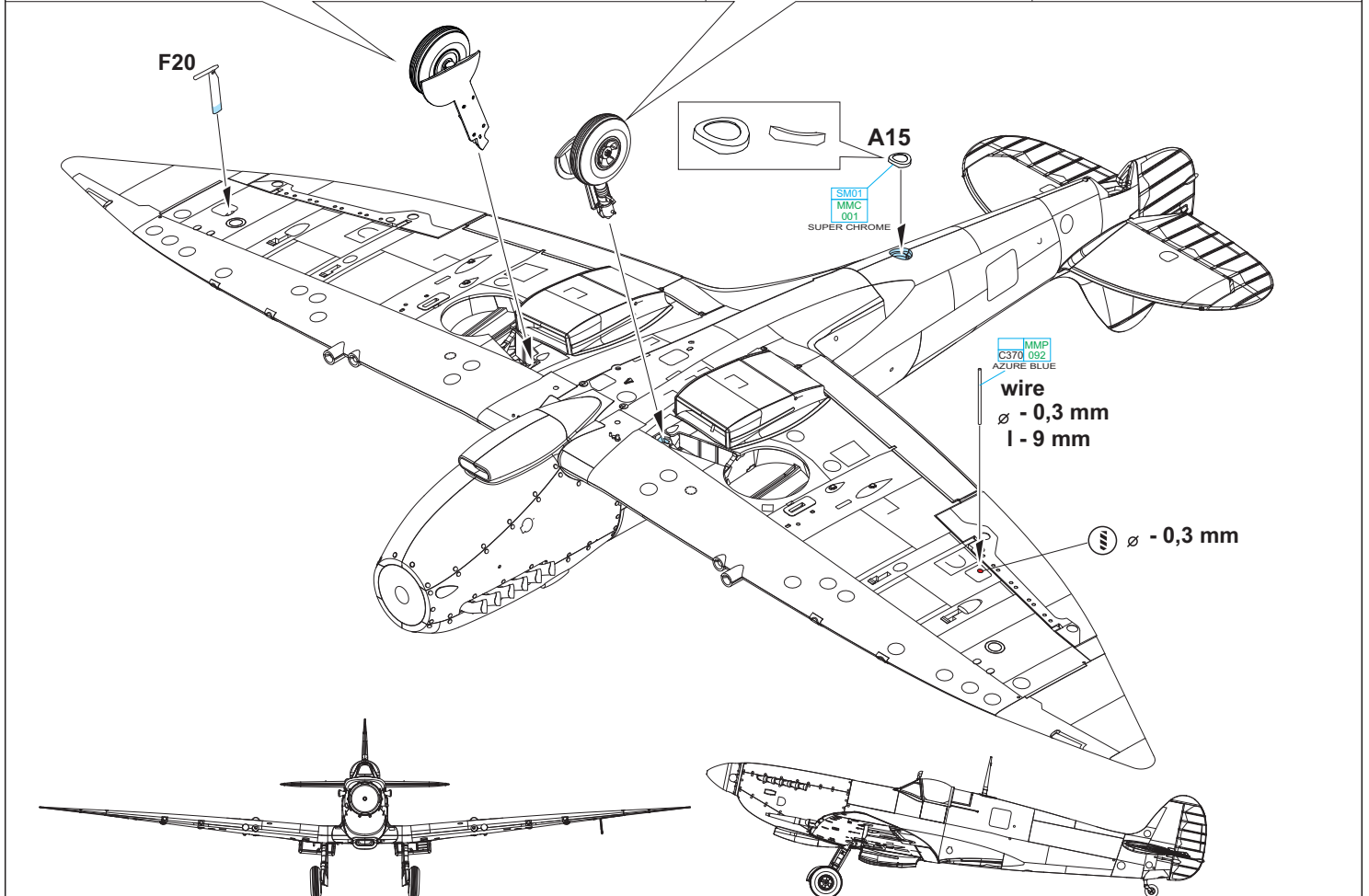
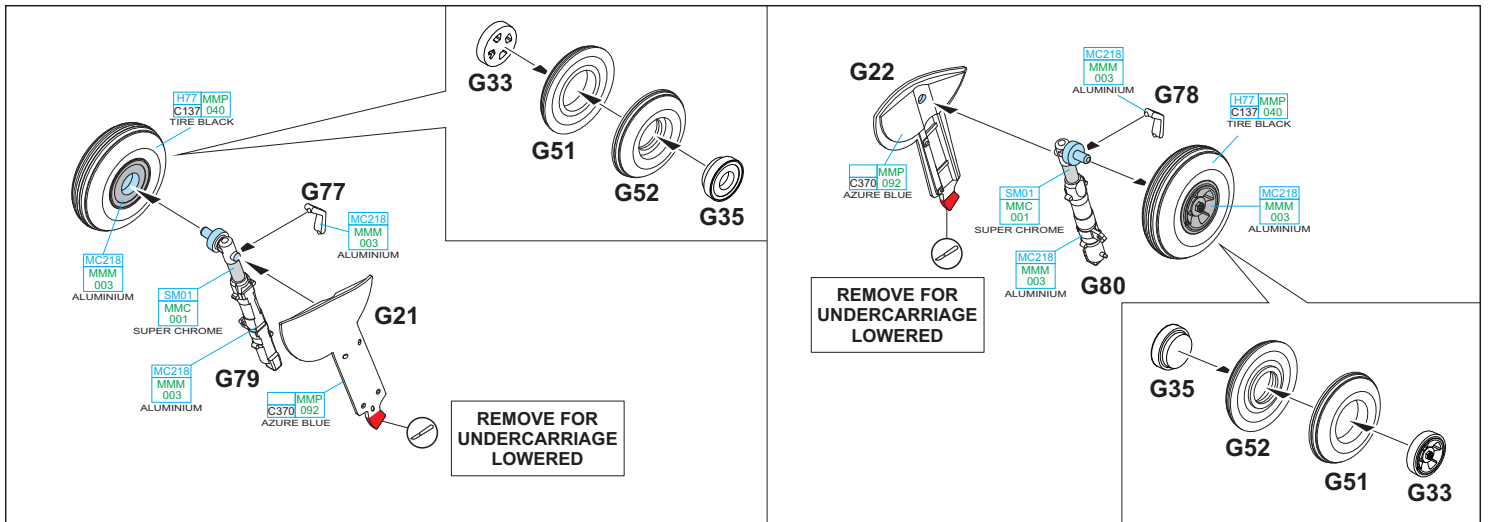



K

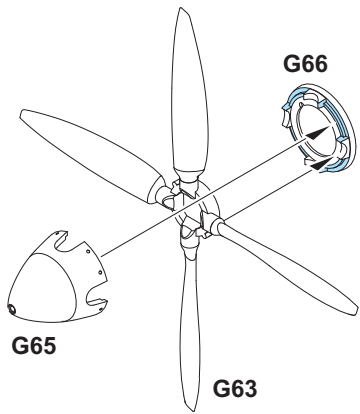

OPEN CANOPY

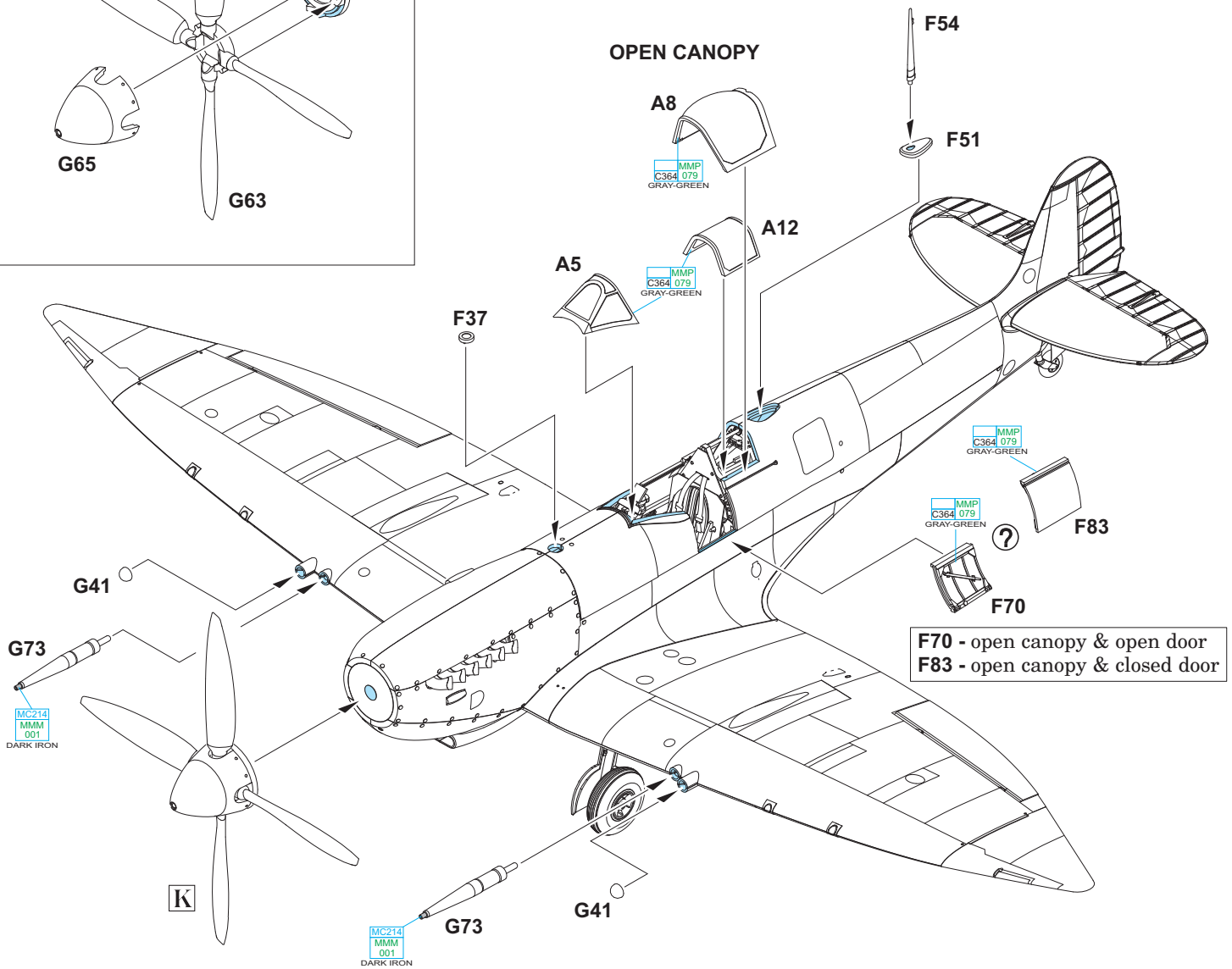

F70 - open canopy & open door  
 F83 - open canopy & closed door

?

CLOSED CANOPY

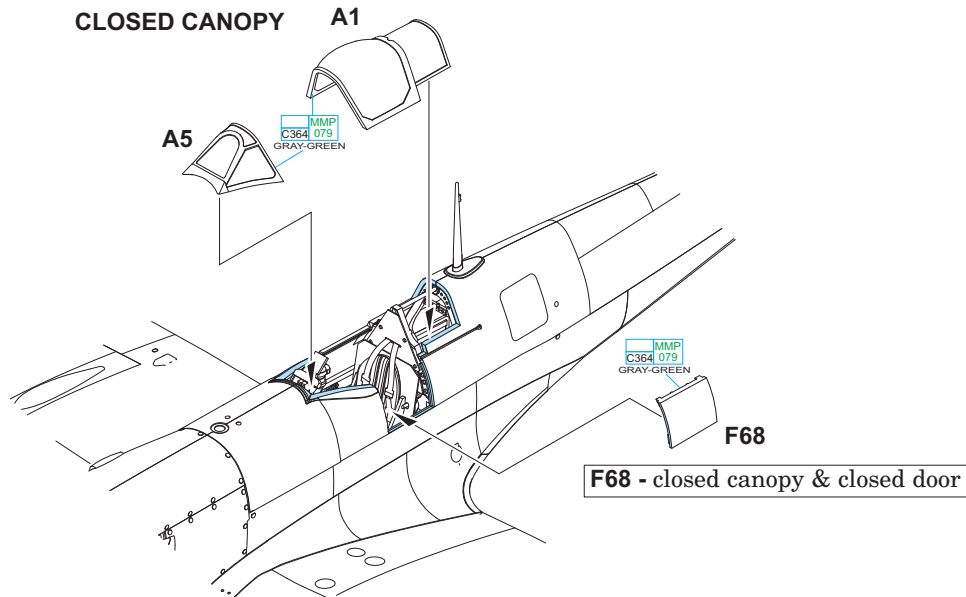

F68 - closed canopy & closed door

# A JF587, Lt. J.E. Gasson, 92. squadrona, Marcianise, Itálie, začátek roku 1944

Původní stíhací 92. squadrona, účastníci se bojí 1. světové války, byla v srpnu 1919 rozpuštěna. Dne 10. října 1939 byla ustavena jednotka se stejným číselným označením, jejíž výzbroj zpočátku tvořily Bristolův Blenheim. Již na počátku roku 1940 obdržela Spitfiry, s nimiž prošla boji nad Dunkerque a Bitvou o Británii. V únoru 1942 byla odeslána do severní Afriky, kde působila proti německým a italským ozbrojeným silám. Po ukončení bojů v Africe následovalo nasazení nad Maltou a Sicílií, poté byla jednotka nasazena nad Itálií. Rozpuštěna byla 30. prosince 1946 v rakouském Zeltwegu. Během 2. světové války dosáhla nejvyššího počtu sestřelů protivníka mezi perutěmi RAF, 317 vítězství. Stroje 92. squadrony nesly kamufláž Desert scheme. To tvořily barvy Dark Earth a Middle Stone na horních plochách, spodní plochy kryla barva Azure Blue. Barvu písmen kódového označení squadrony se nepodařilo jednoznačně určit, prameny uvádějí modrou i červenou. Na obou stranách trupu je znak Desert Air Force.

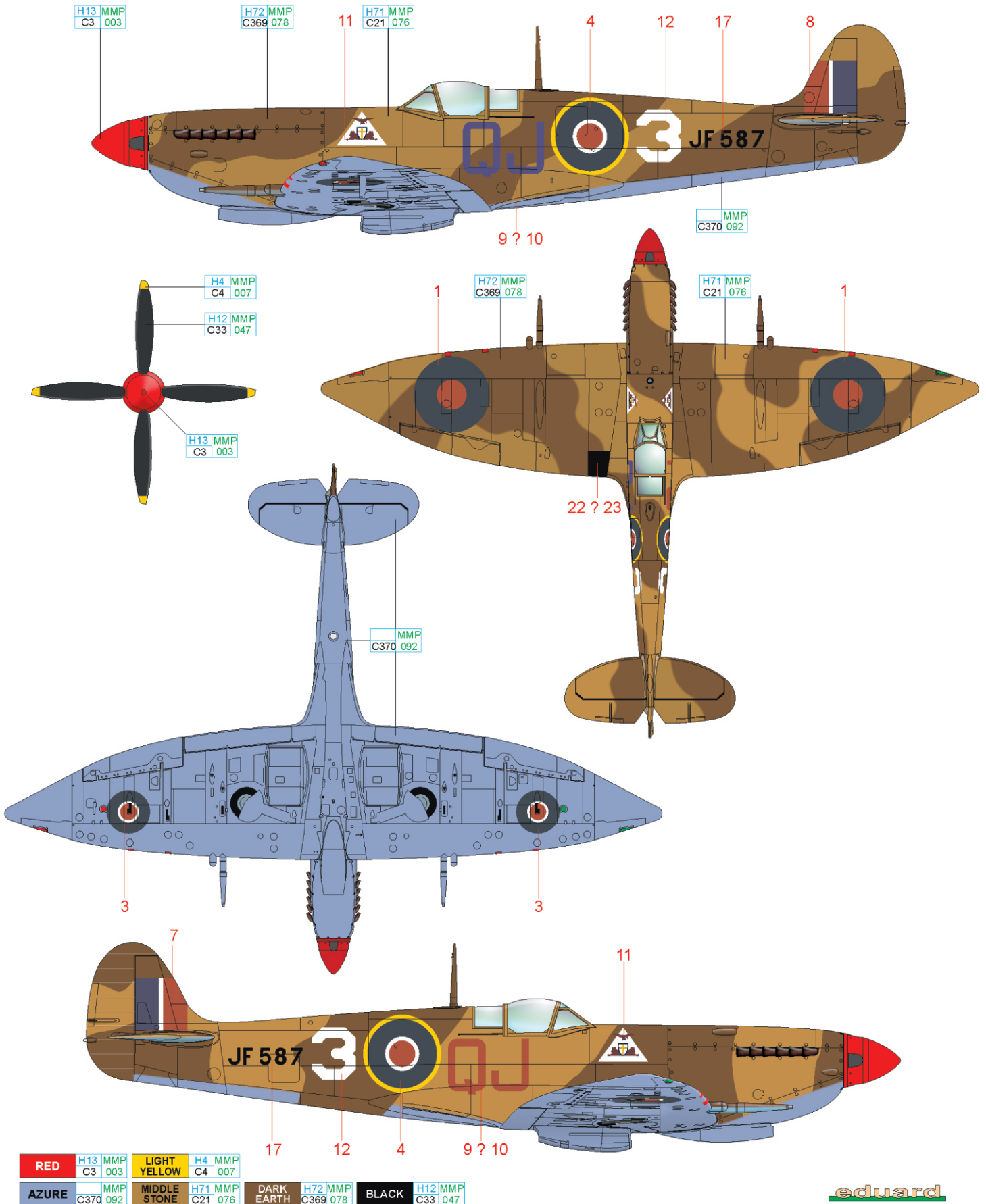

# B JF364, 32. squadrona, Foggia, Itálie, začátek roku 1944

Tento Spitfire Mk.VIII v kamuflážním zbarvení používaném u stíhacích strojů létajících ve vysokých výškách, tzv. High altitude fighter camouflage scheme, používala 32. squadrona RAF. Horní a boční plochy kryla barva Medium Sea Gray, zatímco spodní plochy byly kamuflovány barvou PRU Blue. Výsostné znaky sestávající pouze z červené a modré barvy, byly jen na horních plochách křídla a na bocích trupu, bílá barva byla vynechána také u označení na kýlovce.

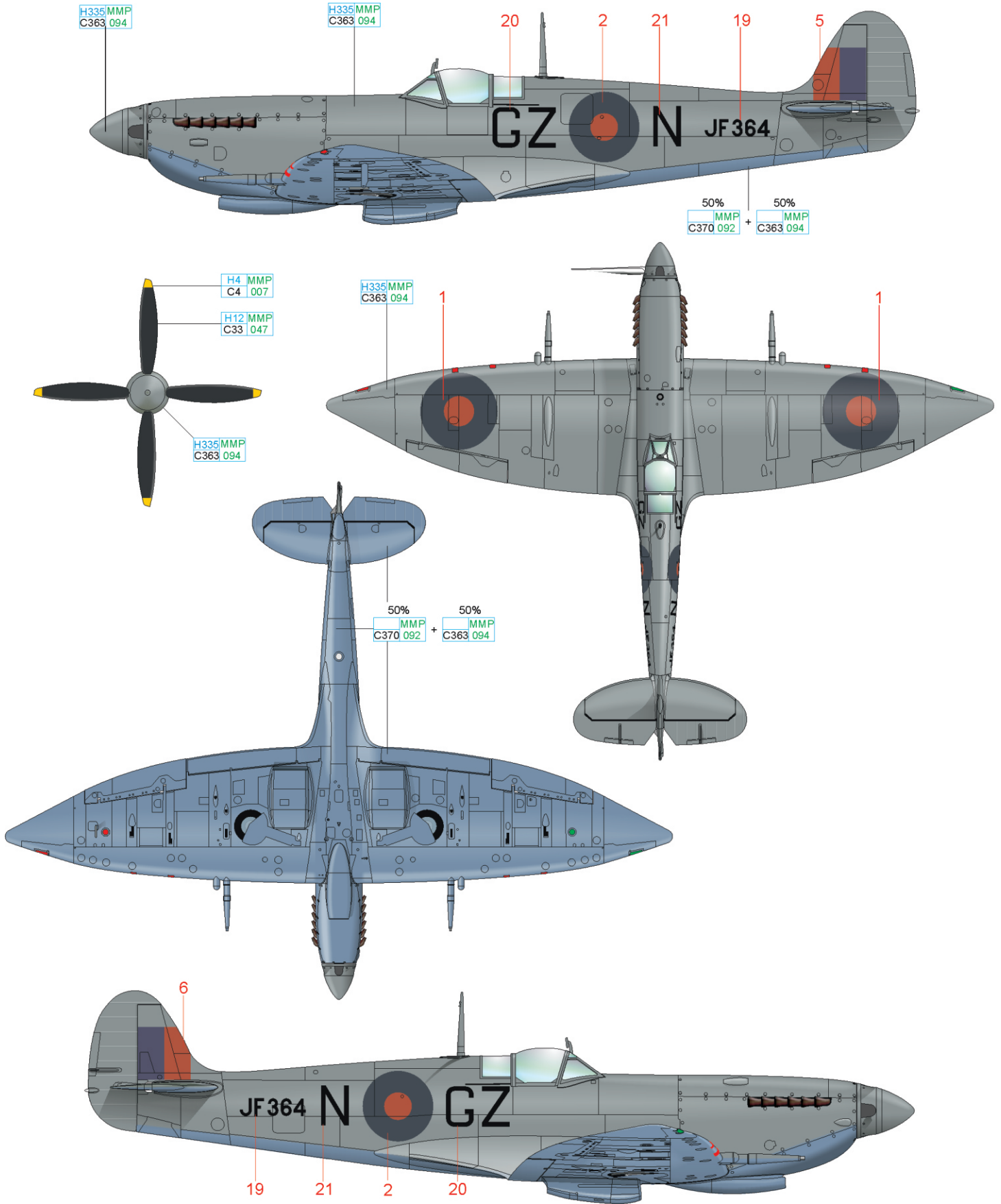

LIGHT YELLOW	H4 MMP C4 007	BLACK	H12 MMP C33 047	MEDIUM SEA GRAY	H335 MMP C363 094	PRU BLUE	50% MMP C370 092 + 50% MMP C363 094
--------------	---------------	-------	-----------------	-----------------	-------------------	----------	-------------------------------------

# Spitfire HF Mk.VIII

# STENCILING POSITIONS

